

INNOCELL AT KOWLOON WEST RATE CARD

ROOM TYPE	Daily Rate (HK\$)	Short Stay Rate (HK\$)	Long Stay Rate (HK\$)
	6 ~ 29 nights	30 ~ 179 nights	1 year
STUDIO QUEEN approx. 150 sf (max. 2 person)	\$450 /night	\$9,680 /month	\$8,800 /month

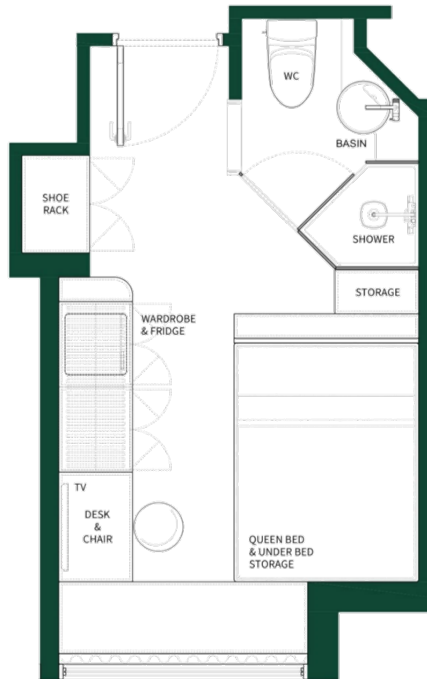

The layout plan shown is for reference only. Actual unit layouts and sizes may vary.

360° Virtual Tours

* IMPORTANT NOTES :

- (i) Room Floor Zones: 6/F - 29/F
- (ii) Category A application: Long Stay Rate applied
Category B application: Daily Rate & Short Stay Rate applied
Category C application: Daily Rate applied for 6 ~ 90 nights
- (iii) Minimum licence term of Category B and C Application is 6 nights

Terms and Conditions:

- Subject to the InnoCell Admission Committee approval.
- No tax shall be applied to room rate.
- Room Rental including utilities, in-room air-conditioning and housekeeping services once a week;
- All reservations are subject to availability and room rates are subject to change without prior notice.
- No cancellation nor amendment is allowed after the booking is confirmed and all payments made will not be refunded.
- Check-in Time: 3:00 pm and Check-out Time: 12:00 noon.

innocell.general@hkstp.org

<https://www.hkstp.org/what-we-offer/infrastructure/innocell/>

Effective on 27 Mar 2024